

**This electronic collection of documents is provided
for the convenience of the user
and is Not a Certified Document –**

**The documents contained herein were originally issued
and sealed by the individuals whose names and license
numbers appear on each page, on the dates appearing
with their signature on that page.**

**This file or an individual page
shall not be considered a certified document.**

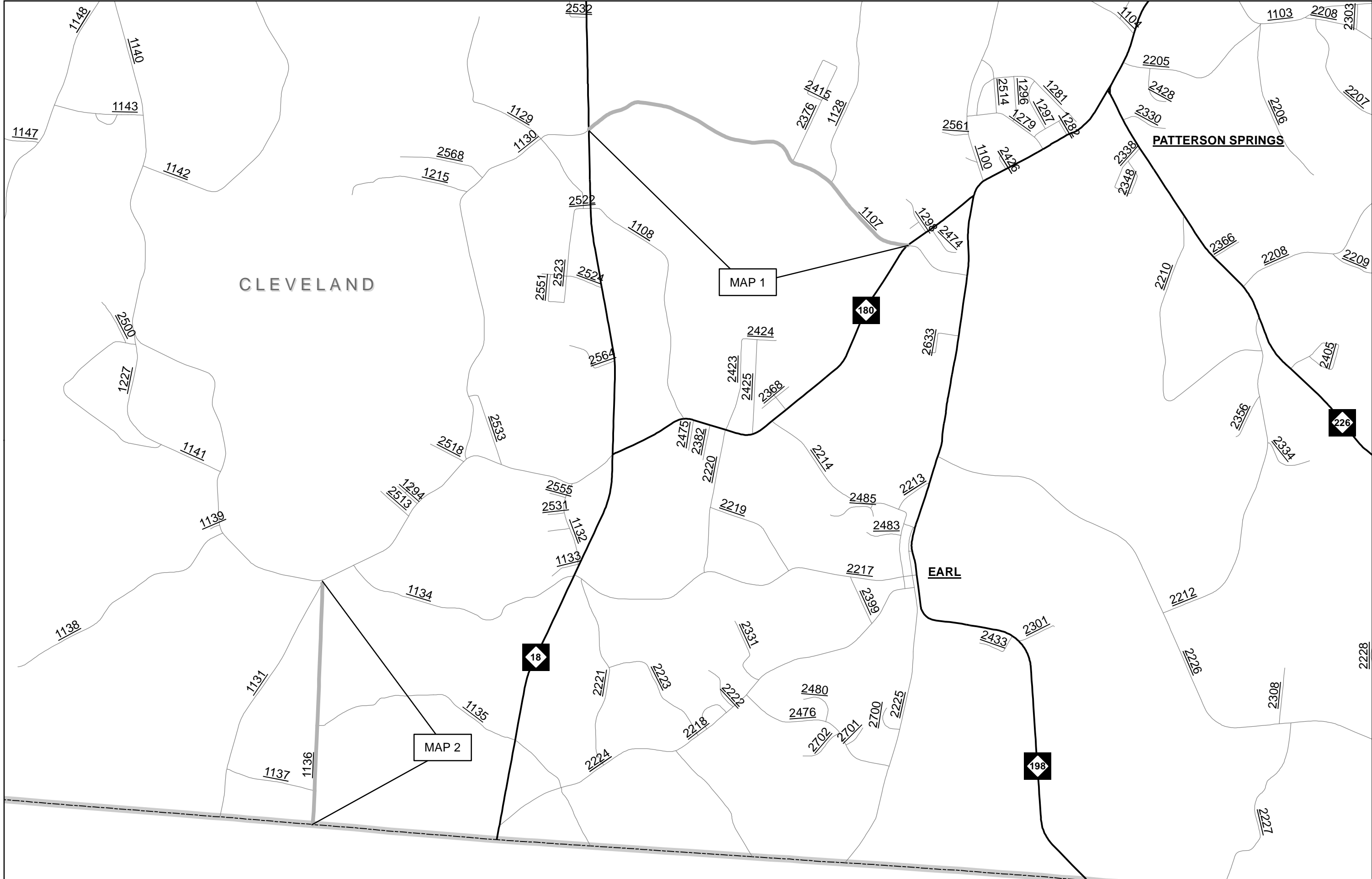

CLEVELAND

MAP 1

MAP 2

EARL

PATTERSON SPRINGS



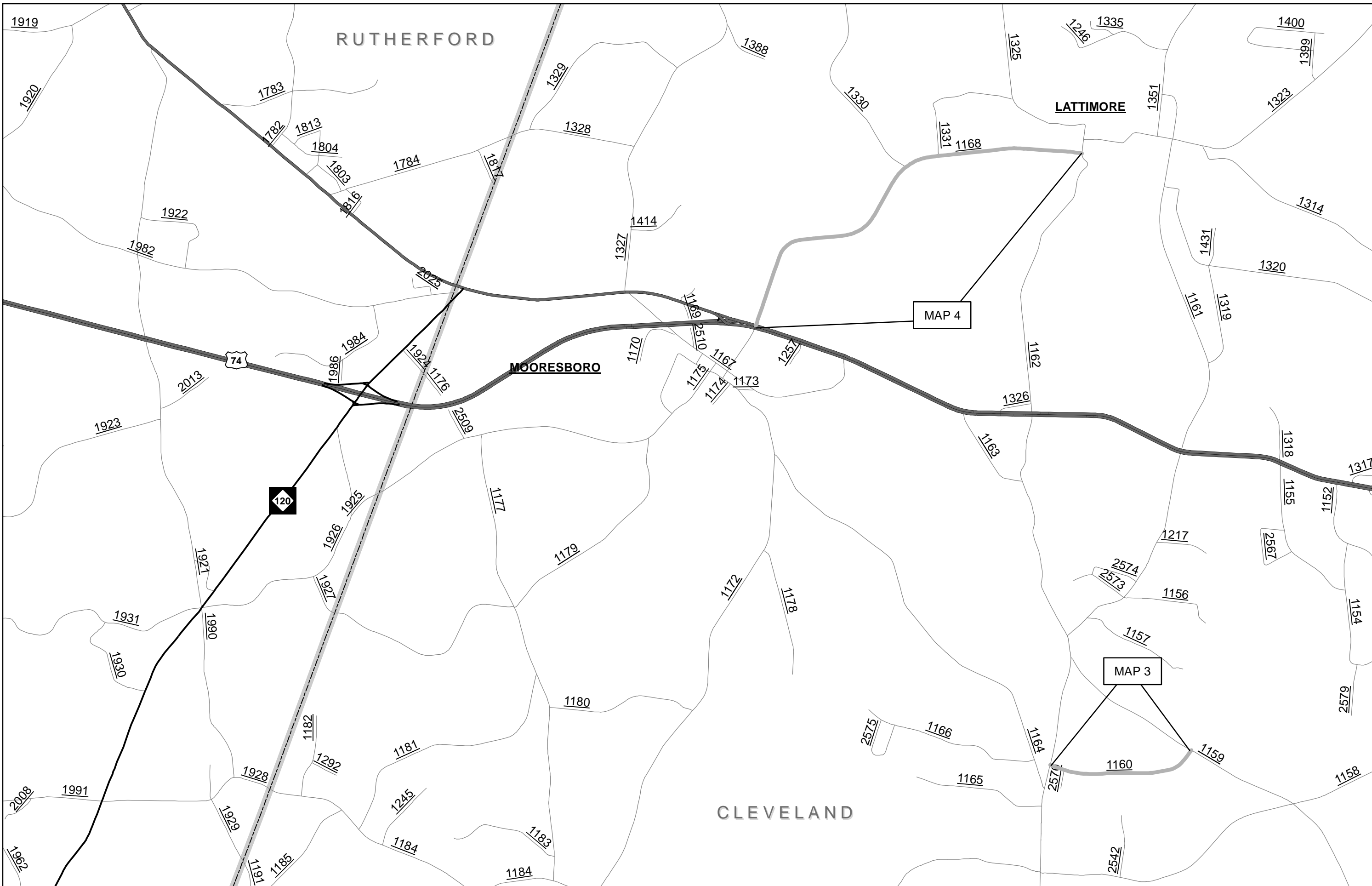

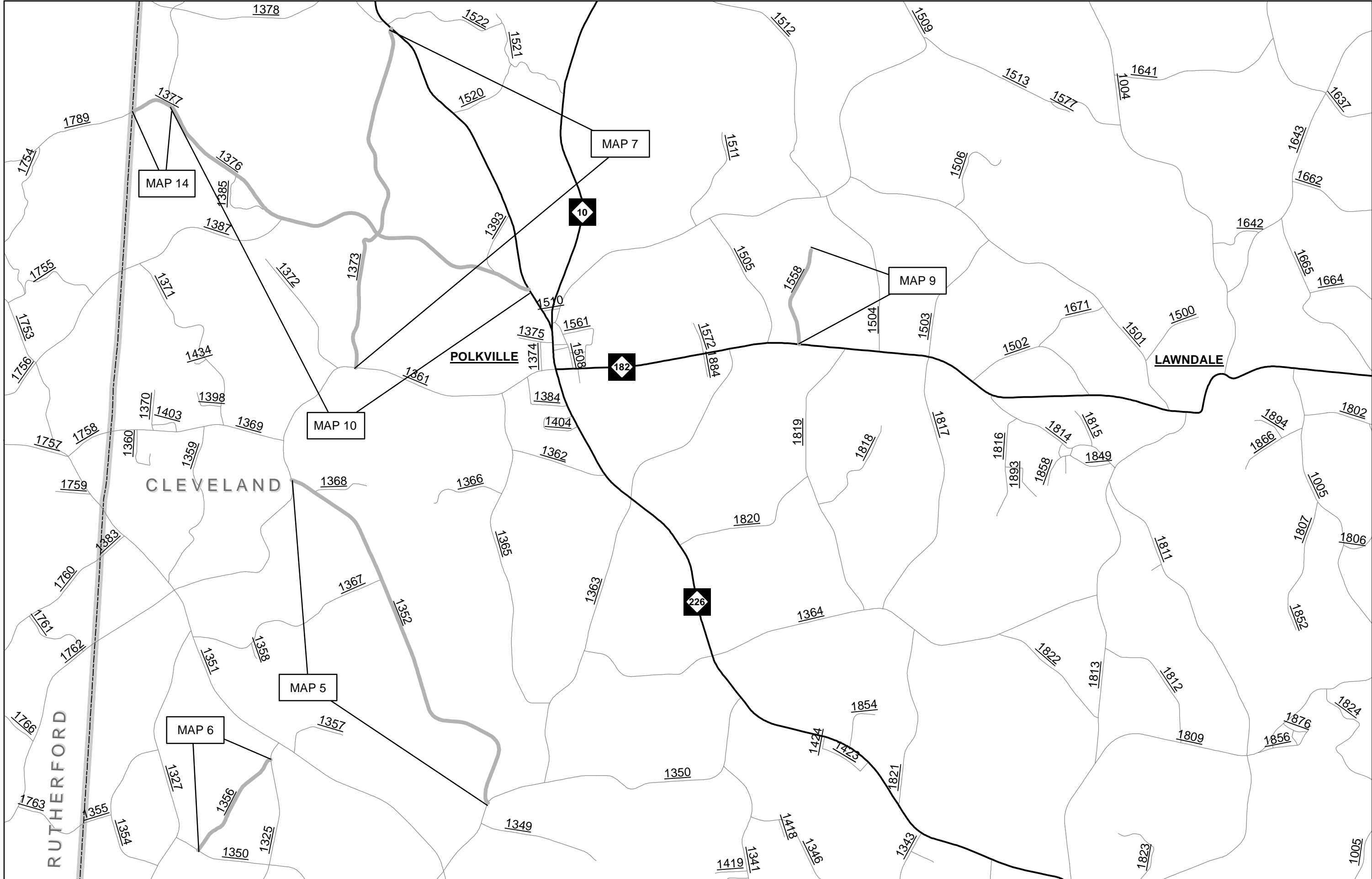

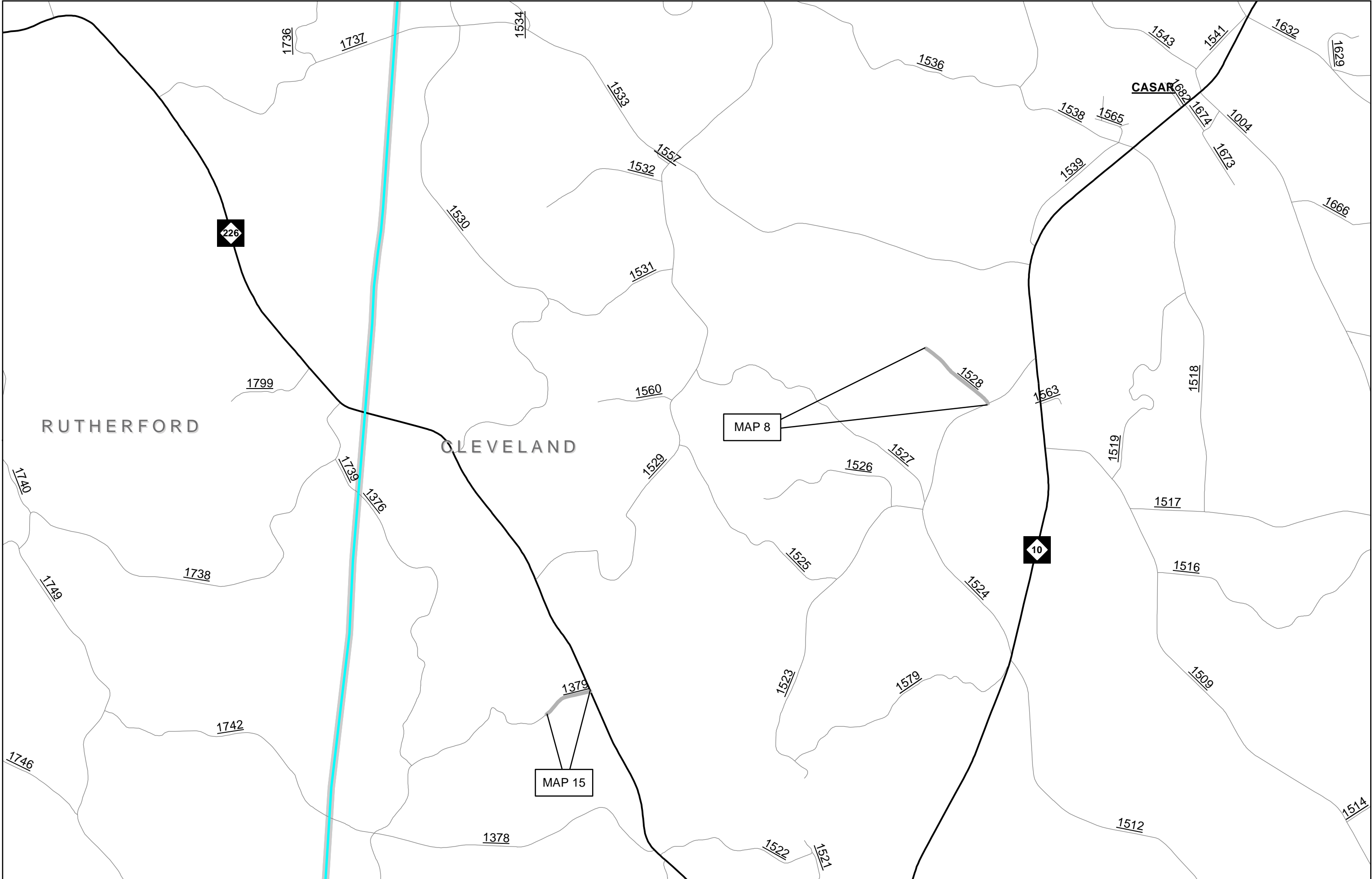

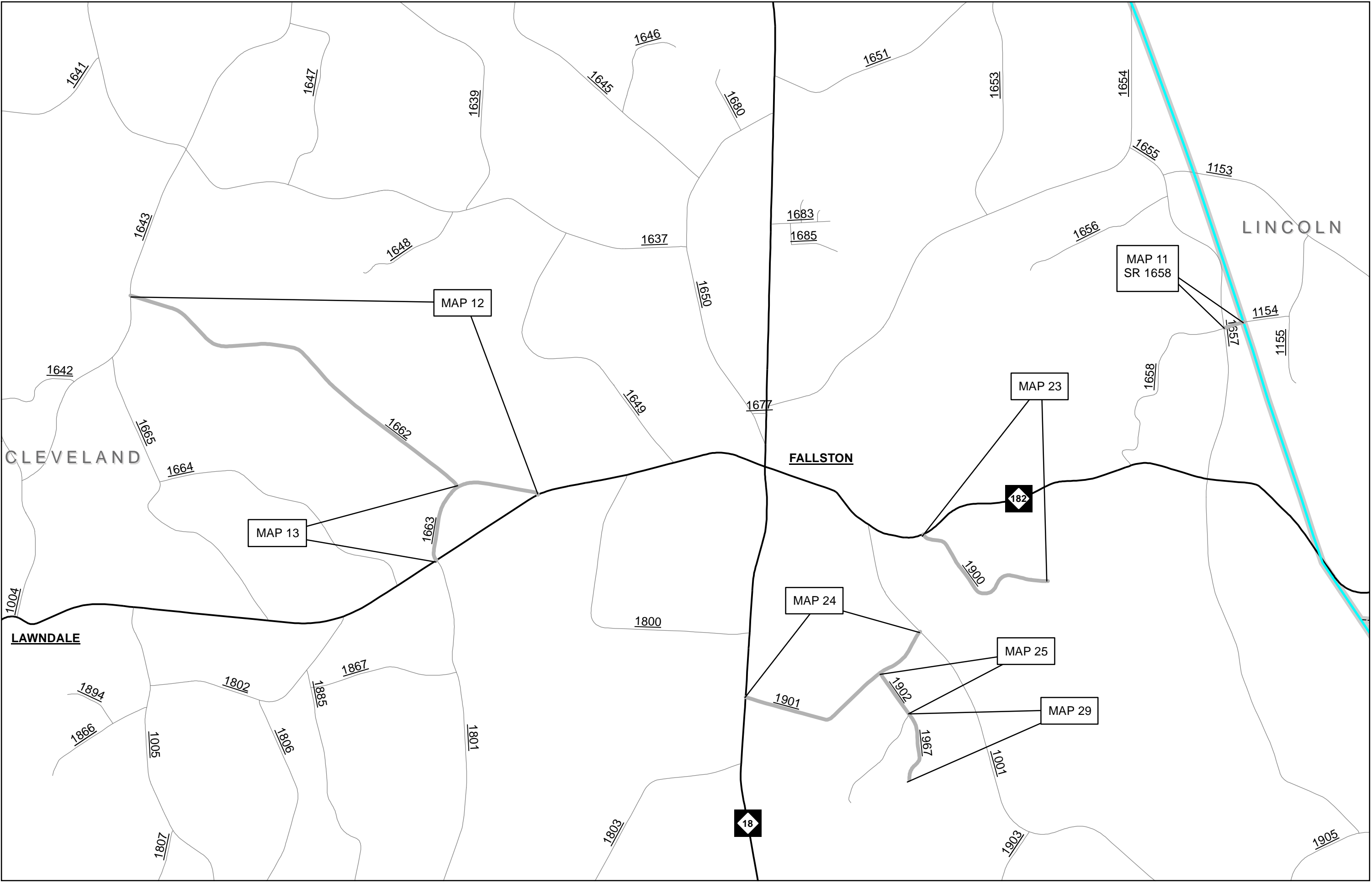

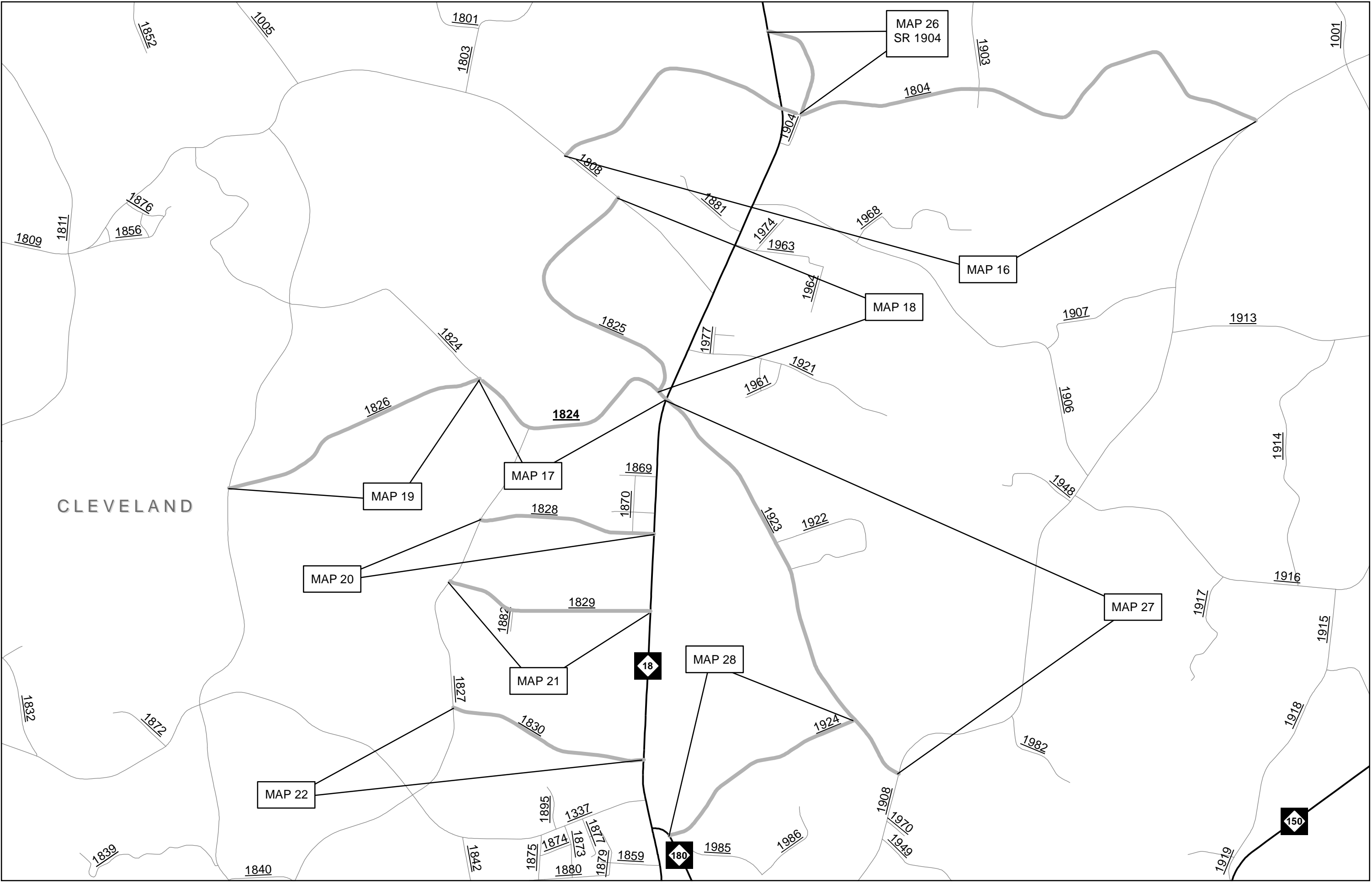

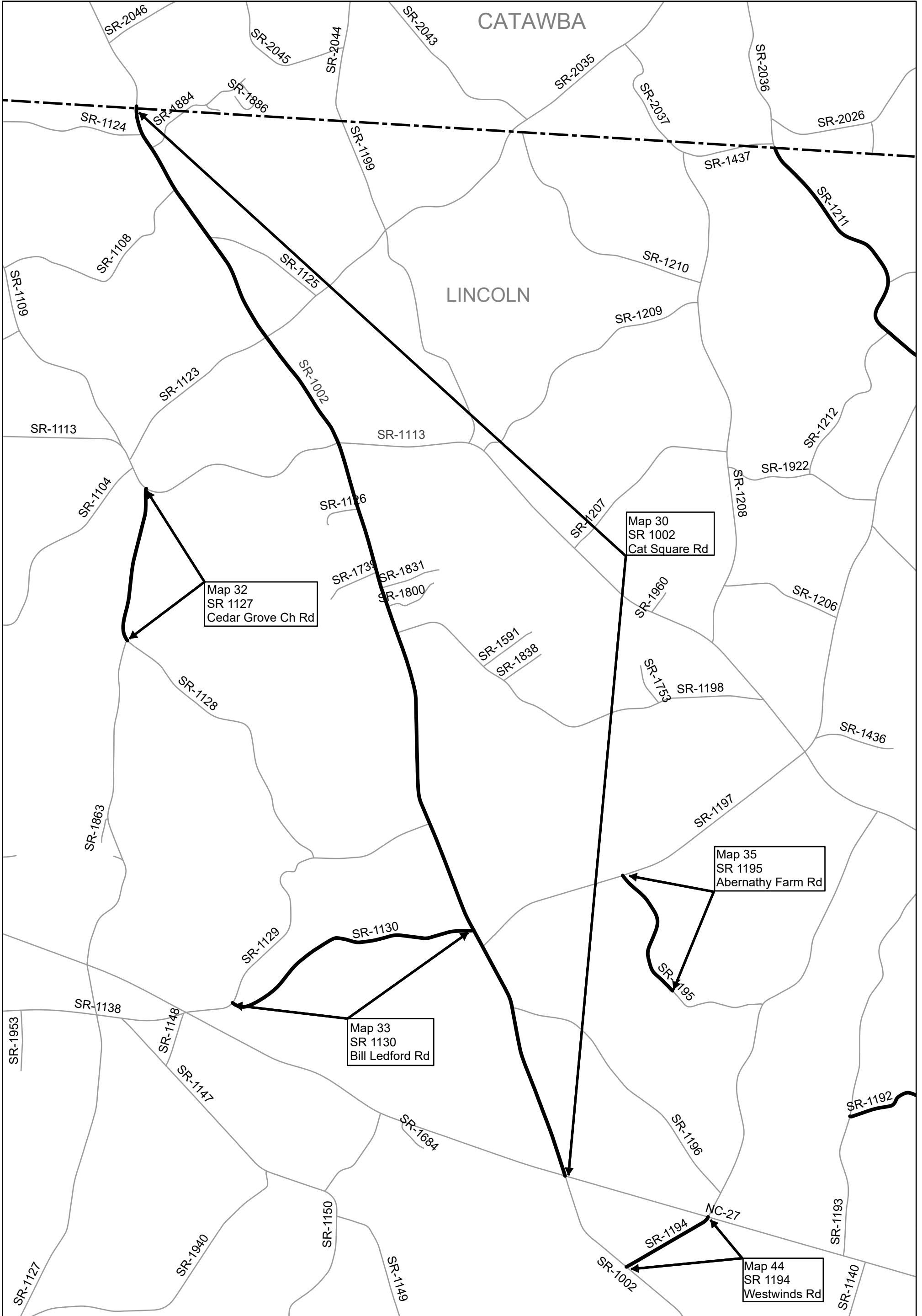

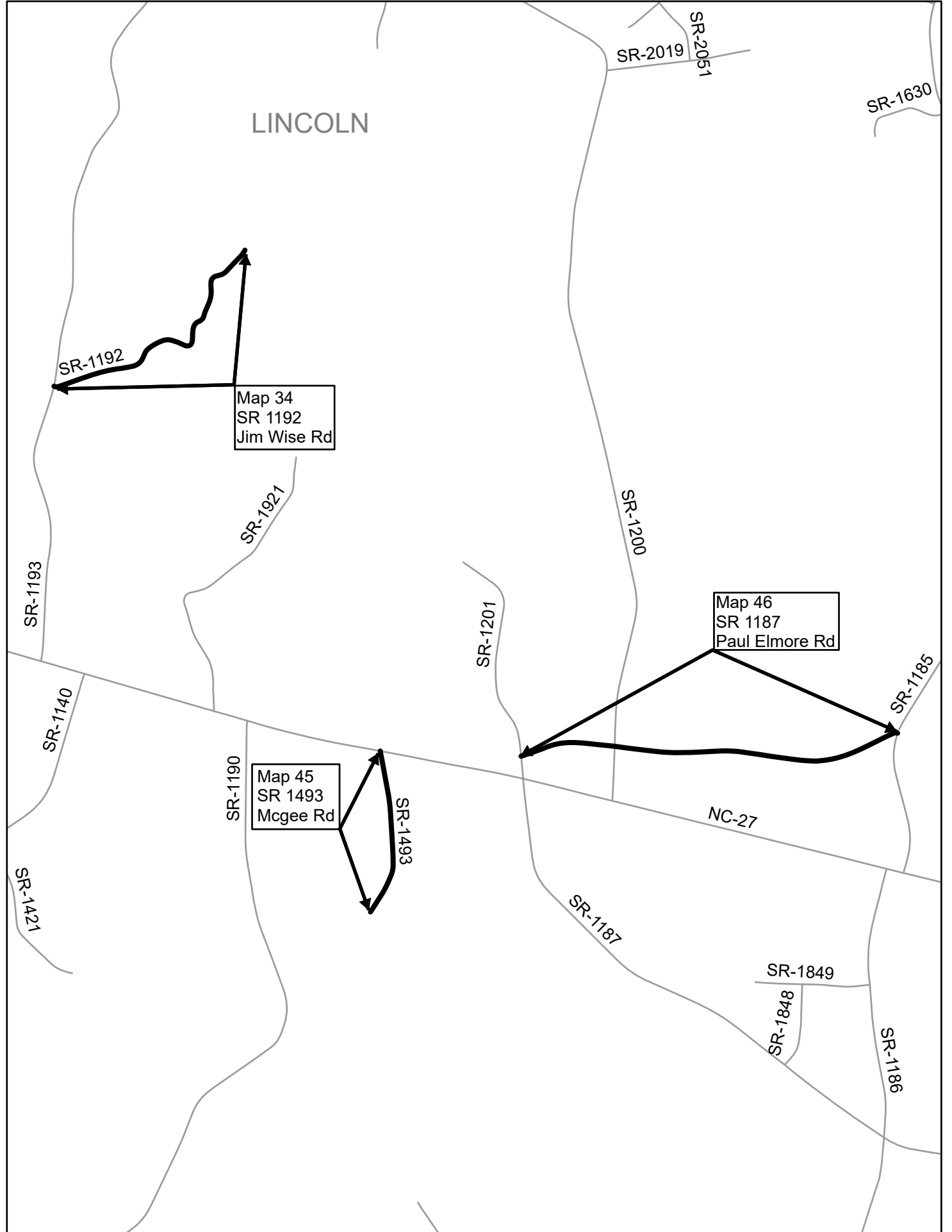
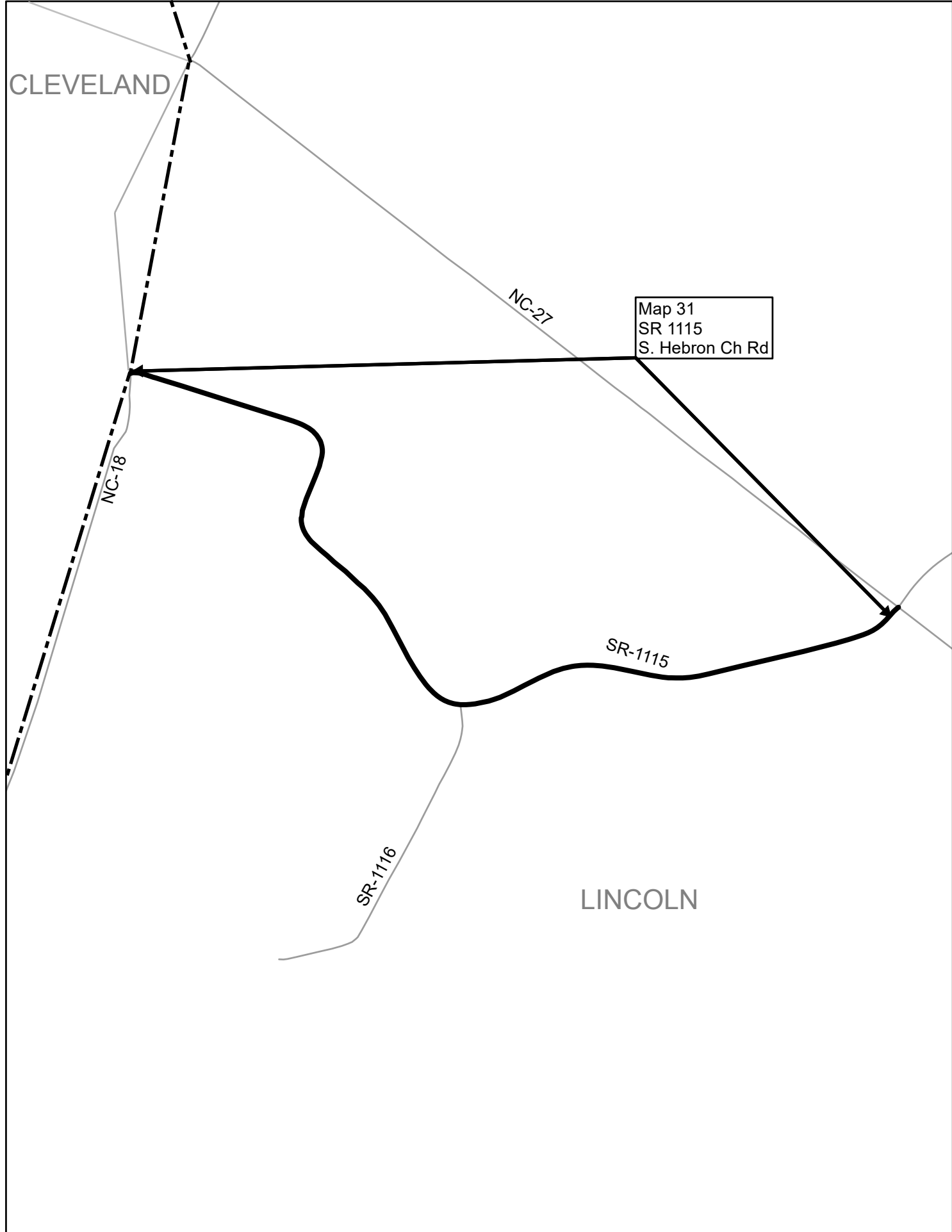

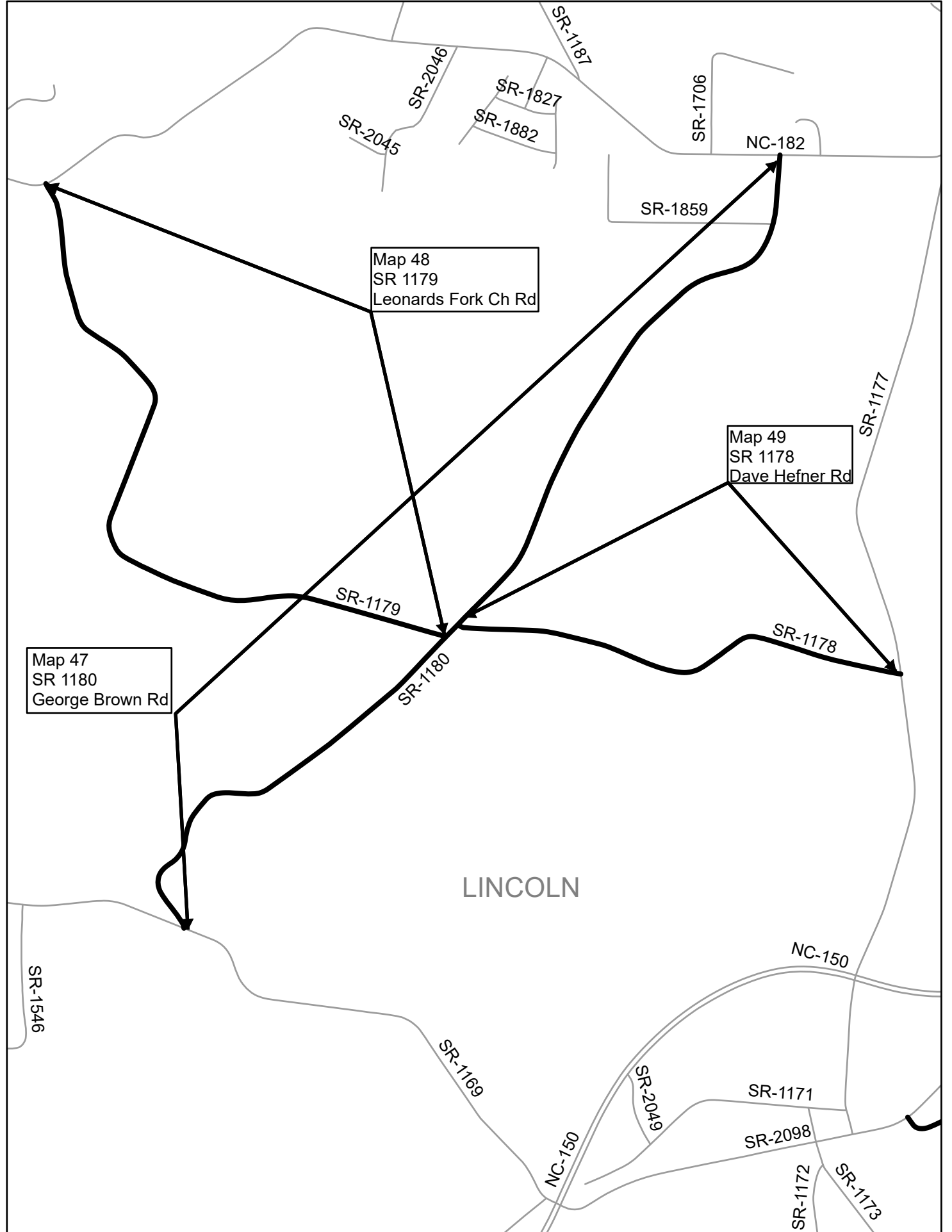
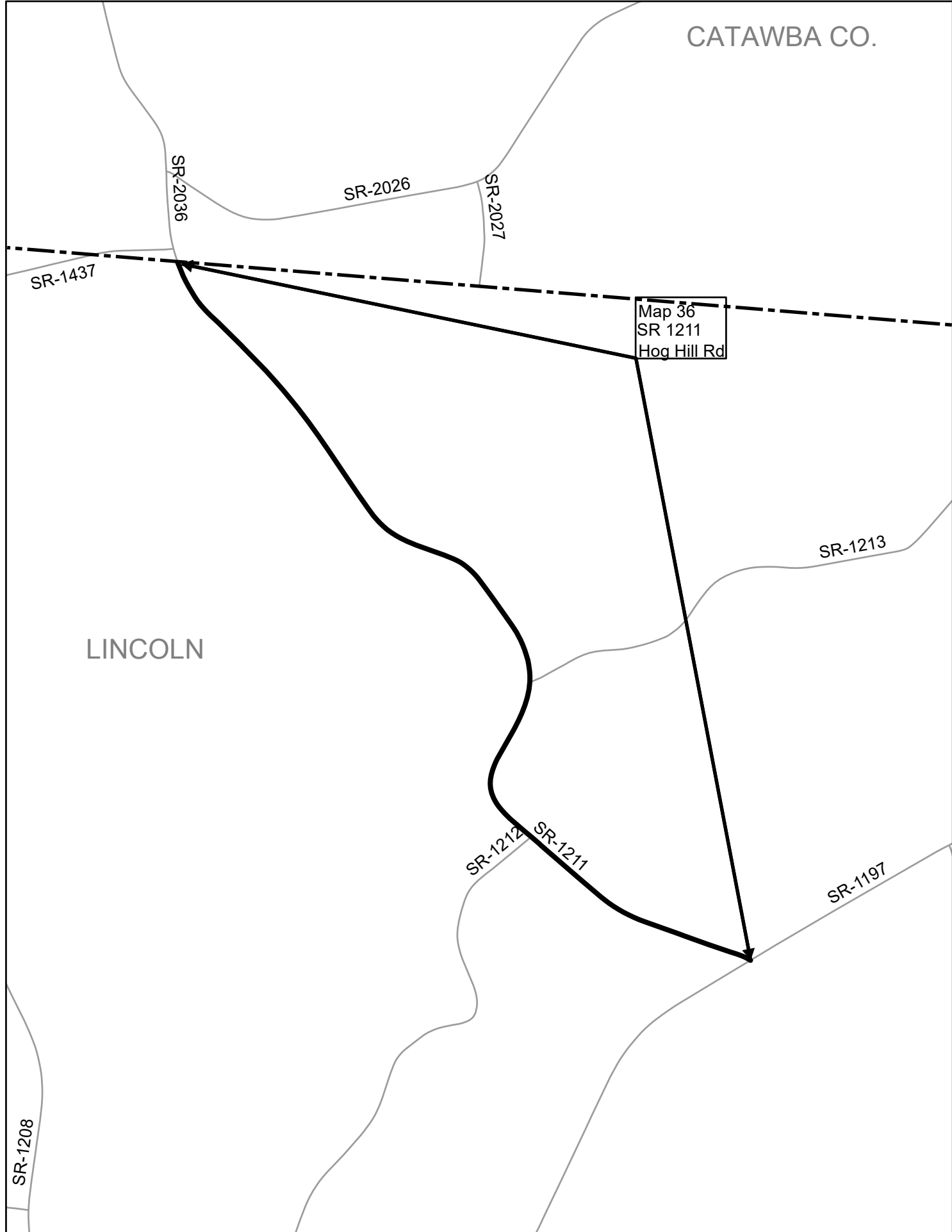

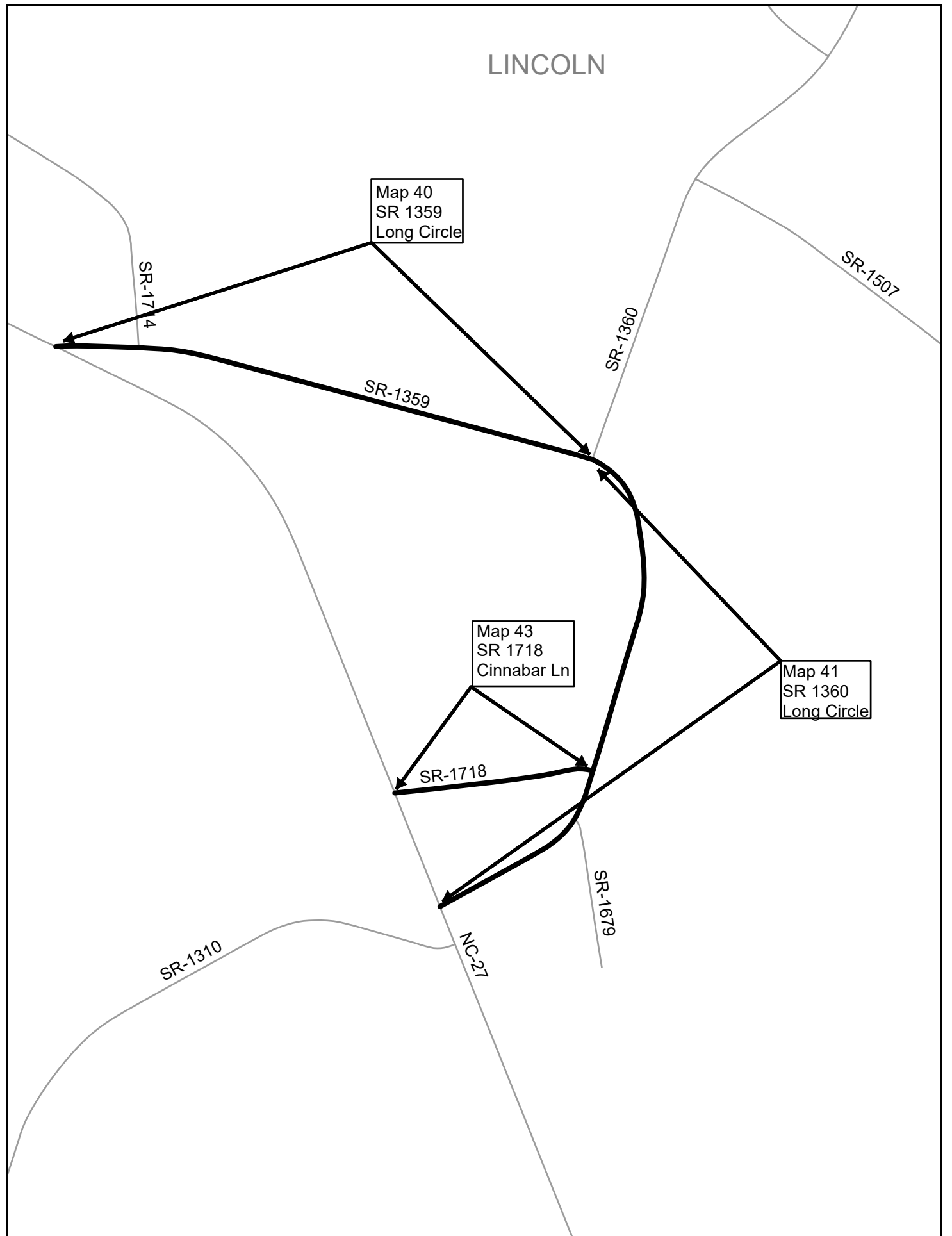
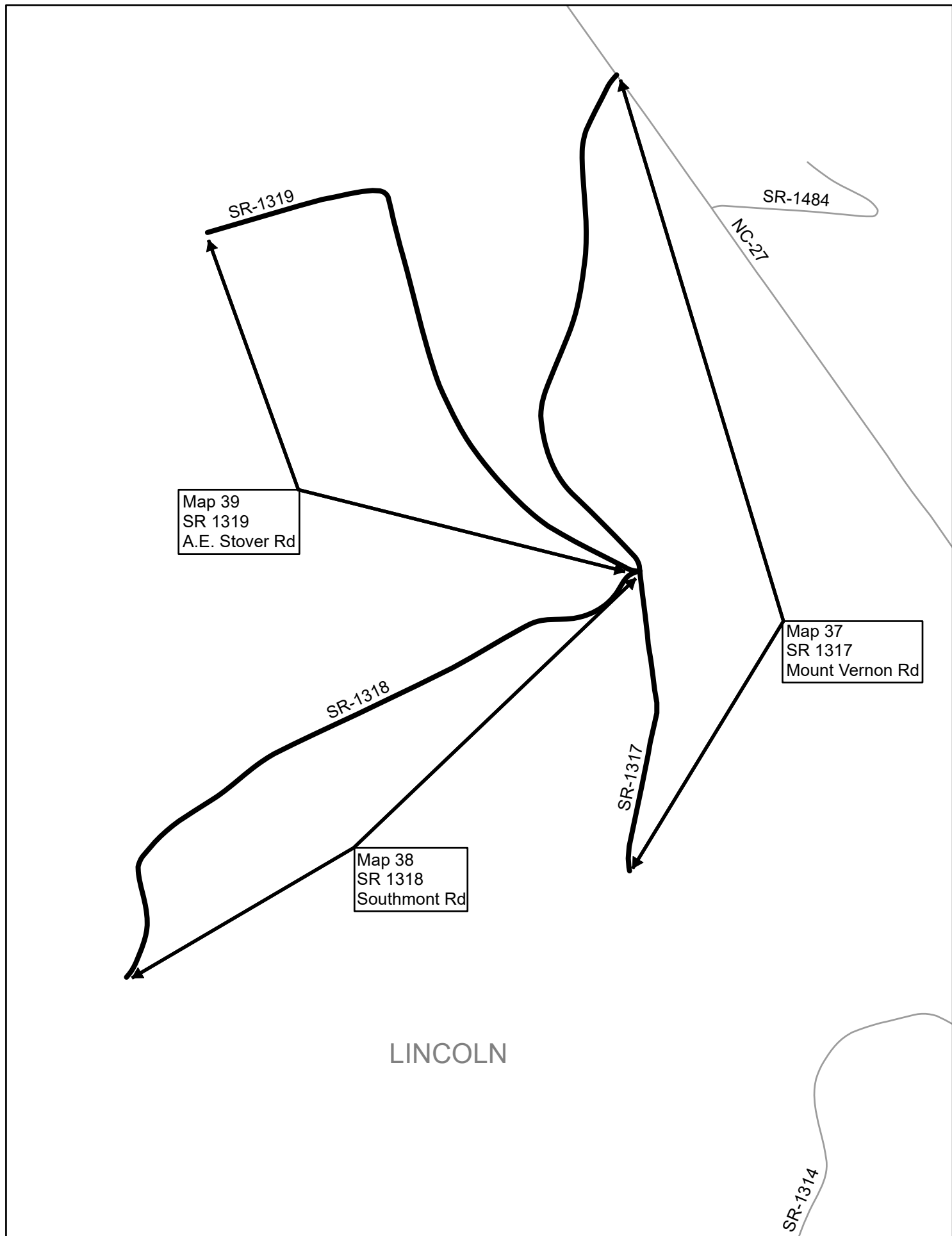

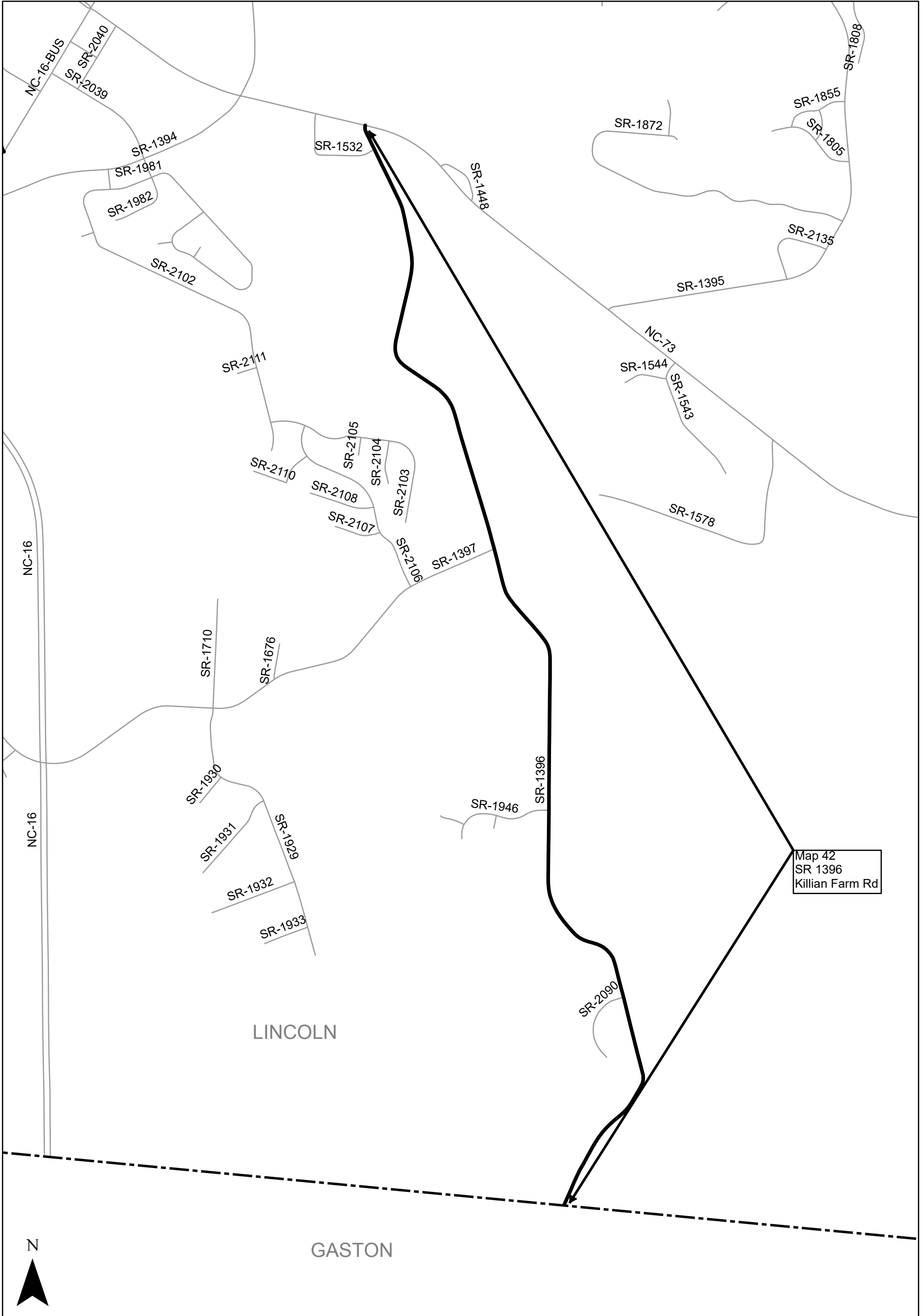

Map 42
 SR 1396
 Killian Farm Rd

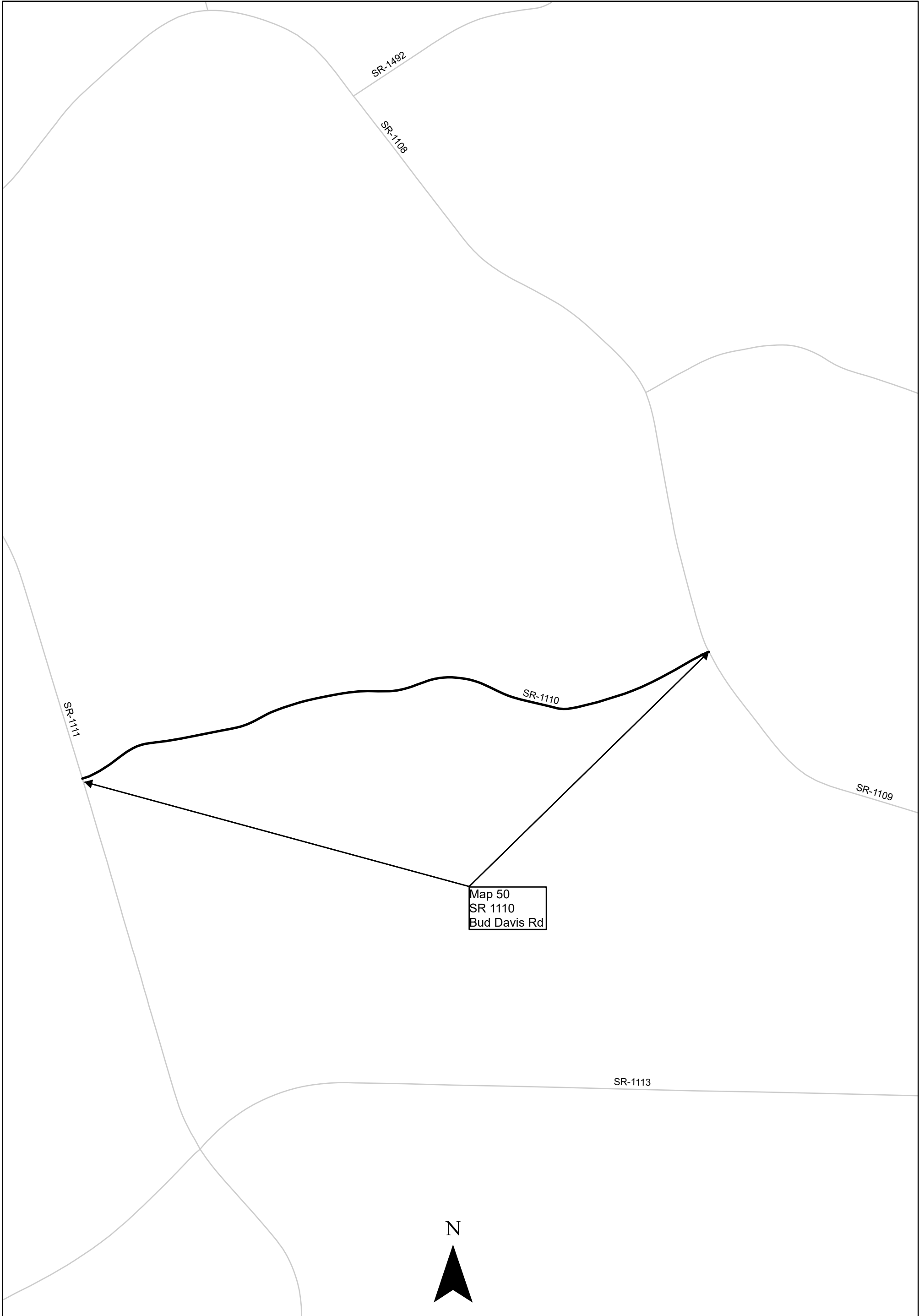

Map 50
SR 1110
Bud Davis Rd



PROJ. REFERENCE NO. 2019-2020	SHEET NO. 14	TOTAL SHEETS 17
STATE PROJ. NO. 2018CPT.12.25.20232	F. A. PROJ. NO. STATE FUNDED	DESCRIPTION CLEVELAND
2018CPT.12.25.20552	STATE FUNDED	LINCOLN

PAVEMENT SCHEDULE	
F	ASPHALT SURFACE TREATMENT, DOUBLE SEAL USING A TOP LAYER OF LIGHTWEIGHT AGGREGATE AND A BOTTOM LAYER OF #78M AGGREGATE
G	ASPHALT SURFACE TREATMENT, FOG SEAL USING A TARGET APPLICATION RATE OF 0.12 GAL/SY, +/- 0.03 GAL/SY

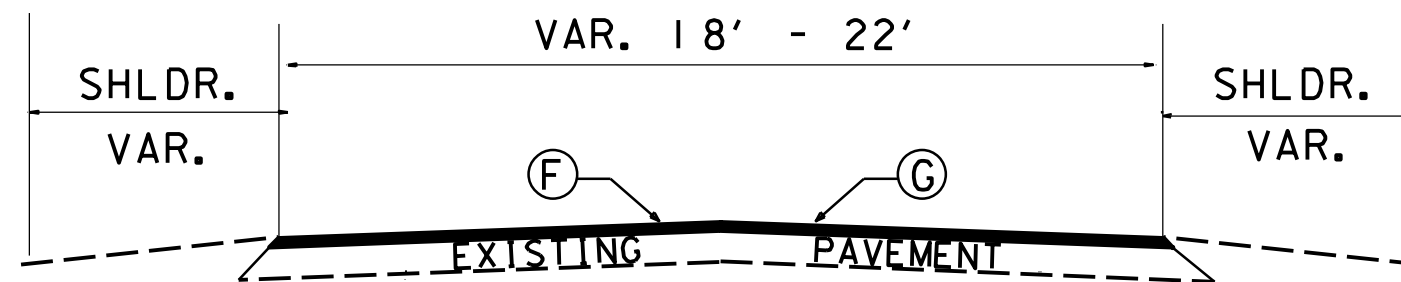

TYPICAL SECTION NO. 2

PAVEMENT PRESERVATION
2019 - 2020
CLEVELAND & LINCOLN COS.

PROJECT NO.	SHEET NO.	TOTAL NO.
2018CPT.12.25.20232, 2018CPT.12.25.20552	15	17

SUMMARY OF QUANTITIES

PROJECT NO	COUNTY	MAP NO	ROUTE	DESCRIPTION	TYP NO	LANES	FINAL SURFACE TESTING REQUIRED	WARM MIX ASPHALT REQUIRED	LENGTH	WIDTH	1803500000-E	1820000000-E	1838000000-E	2143000000-E	
											ASPHALT SURFACE TREATMENT, DOUBLE SEAL	ASPHALT SURFACE TREATMENT, FOG SEAL	EMULSION FOR ASPHALT SURFACE TREATMENT	BLOTTING SAND	
											SY	SY	GAL	TON	
2018CPT.12.25.20232	Cleveland	1	SR 1107 (DAVIS RD)	NC 18 TO NC 180	1	2	NO	NO	2.04	18	23,697	23,697	11,849	15	
2018CPT.12.25.20232	Cleveland	2	SR 1136 (OLD BUFFALO CH. RD.)	SR 1140 TO SC STATE LINE	1	2	NO	NO	1.32	20	17,037	17,037	8,519		
2018CPT.12.25.20232	Cleveland	3	SR 1160 (BARCLAY RD)	SR 1161 TO SR 1159	1	2	NO	NO	0.81	20	10,454	10,454	5,227		
2018CPT.12.25.20232	Cleveland	4	SR 1168 (LATTIMORE RD)	SR 1162 TO US 74	1	2	NO	NO	2.28	18	26,484	26,484	13,242	15	
2018CPT.12.25.20232	Cleveland	5	SR 1352 (CROWDER RIDGE RD.)	SR 1350 TO SR 1361	1	2	NO	NO	3.02	18	35,080	35,080	17,540		
2018CPT.12.25.20232	Cleveland	6	SR 1356 (DOTY RD.)	SR 1350 TO SR 1325	1	2	NO	NO	0.86	20	11,100	11,100	5,550	15	
2018CPT.12.25.20232	Cleveland	7	SR 1373 (5 POINTS RD.)	SR 1361 TO NC 226	1	2	NO	NO	2.61	VAR. 18-20	33,350	33,350	16,675		
2018CPT.12.25.20232	Cleveland	8	SR 1528 (LARGO DR.)	SR 1524 TO DEAD END	1	2	NO	NO	0.45	20	5,808	5,808	2,409		
2018CPT.12.25.20232	Cleveland	9	SR 1558 (CHARLIE RANDAL RD.)	NC 182 TO DEAD END	1	2	NO	NO	0.72	18	8,364	8,364	4,182		
2018CPT.12.25.20232	Cleveland	10	SR 1376 (HOLLIS RD.)	NC 226 TO SR 1377	1	2	NO	NO	3.07	20	39,624	39,624	19,812		
2018CPT.12.25.20232	Cleveland	11	SR 1658 (GREEN FARM RD.)	SR 1657 TO LINCOLN COUNTY LINE	1	2	NO	NO	0.09	18	1,045	1,045	523		
2018CPT.12.25.20232	Cleveland	12	SR 1662 (WILL DIXON RD.)	NC 182 TO SR 1643	1	2	NO	NO	2.07	20	26,717	26,717	13,359		
2018CPT.12.25.20232	Cleveland	13	SR 1663 (PHILADELPHIA RD.)	NC 182 TO SR 1662	1	2	NO	NO	0.35	18	4,066	4,066	2,033		
2018CPT.12.25.20232	Cleveland	14	SR 1377 (HOLLIS RD.)	RUTHERFORD CO. LINE TO SR 1376	1	2	NO	NO	0.33	18	3,834	3,834	1,917		
2018CPT.12.25.20232	Cleveland	15	SR 1379 (MT. HARMONY CH. RD.)	NC 226 TO END OF PAVEMENT	1	2	NO	NO	0.28	20	3,253	3,253	1,627		
2018CPT.12.25.20232	Cleveland	16	SR 1804 (JIM ELLIOT RD./ED HAMRICK RD.)	SR 1908 TO SR 1808	1	2	NO	NO	3.6	20	46,464	46,464	23,232	15	
2018CPT.12.25.20232	Cleveland	17	SR 1824 (DICK SPANGLER RD.)	SR 1826 TO NC 18	1	2	NO	NO	1.05	20	13,552	13,552	6,776		
2018CPT.12.25.20232	Cleveland	18	SR 1825 (PLAINFIELD DR.)	SR 1824 TO SR 1808	1	2	NO	NO	1.32	20	17,037	17,037	8,519		
2018CPT.12.25.20232	Cleveland	19	SR 1826 (CORNWELL RD.)	SR 1824 TO SR 1005	1	2	NO	NO	1.26	20	16,262	16,262	8,131		
2018CPT.12.25.20232	Cleveland	20	SR 1828 (OAKVALE DR.)	NC 18 TO SR 1827	1	2	NO	NO	0.8	18	9,293	9,293	4,647		
2018CPT.12.25.20232	Cleveland	21	SR 1829 (WALLACE GROVE RD.)	NC 18 TO SR 1827	1	2	NO	NO	0.94	20	12,132	12,132	6,066		
2018CPT.12.25.20232	Cleveland	22	SR 1830 (RIDGEDALE DR.)	NC 18 TO SR 1827	1	2	NO	NO	0.91	20	11,745	11,745	5,873		
2018CPT.12.25.20232	Cleveland	23	SR 1900 (PONY BARN RD.)	NC 182 TO DEAD END	1	2	NO	NO	0.7	18	8,131	8,131	4,066		
2018CPT.12.25.20232	Cleveland	24	SR 1901 (CHAROLAIS DR.)	NC 18 TO SR 1001	1	2	NO	NO	0.93	18	10,803	10,803	5,402		
2018CPT.12.25.20232	Cleveland	25	SR 1902 (CHARITY CH. RD.)	SR 1901 TO SR 1967	1	2	NO	NO	0.22	18	2,556	2,556	1,278		
2018CPT.12.25.20232	Cleveland	26	SR 1904 (PLEASANT GROVE CH. RD.)	NC 18 TO SR 1804	1	2	NO	NO	0.5	18	5,808	5,808	2,904		
2018CPT.12.25.20232	Cleveland	27	SR 1923 (E. SANDERS RD.)	NC 18 TO SR 1908	1	2	NO	NO	2.03	18	23,580	23,580	11,790		
2018CPT.12.25.20232	Cleveland	28	SR 1924 (ARLEE DR.)	NC 180 TO SR 1923	1	2	NO	NO	1.02	20	13,165	13,165	6,583		
2018CPT.12.25.20232	Cleveland	29	SR 1967 (CHARITY CH. RD.)	SR 1902 TO DEAD END	1	2	NO	NO	0.31	18	3,601	3,601	1,801		
TOTAL FOR PROJ NO. 2018CPT.12.25.20232											35.89	444,042	444,042	221,532	60
2018CPT.12.25.20552	Lincoln	30	SR 1002 (CAT SQUARE RD.)	CATAWBA COUNTY LINE TO NC 27	1	2	NO	NO	5.88	22	83,480	83,480	41,740	15	
2018CPT.12.25.20552	Lincoln	31	SR 1115 (S. HEBRON CH. RD.)	NC 27 TO NC 18	1	2	NO	NO	1.21	18	14,055	14,055	7,028		
2018CPT.12.25.20552	Lincoln	32	SR 1127 (CEDAR GROVE CH. RD.)	SR 1128 TO SR 1113	1	2	NO	NO	0.78	18	9,060	9,060	4,530		
2018CPT.12.25.20552	Lincoln	33	SR 1130 (BILL LEDFORD RD)	SR 1002 TO SR 1129	1	2	NO	NO	1.36	20	17,553	17,553	8,777		
2018CPT.12.25.20552	Lincoln	34	SR 1192 (JIM WISE RD)	SR 1193 TO DEAD END	1	2	NO	NO	0.69	20	8,906	8,906	4,453		
2018CPT.12.25.20552	Lincoln	35	SR 1195 (ABERNATHY FARM RD.)	SR 1197 TO END PAVEMENT	1	2	NO	NO	0.7	20	8,624	8,624	4,312		
2018CPT.12.25.20552	Lincoln	36	SR 1211 (HOG HILL RD.)	SR 1197 TO CATAWBA COUNTY LINE	1	2	NO	NO	1.61	19	19,741	19,741	9,871	15	
2018CPT.12.25.20552	Lincoln	37	SR 1317 (MOUNT VERNON RD.)	NC 27 TO END MAINT	1	2	NO	NO	1.03	19	12,629	12,629	6,315		
2018CPT.12.25.20552	Lincoln	38	SR 1318 (SOUTHMOND RD.)	SR 1317 TO DEAD END	1	2	NO	NO	0.86	18	9,990	9,990	4,995		
2018CPT.12.25.20552	Lincoln	39	SR 1319 (AE STOVER RD.)	SR 1317 TO CULDESAC	1	2	NO	NO	0.81	19	9,932	9,932	4,966		
2018CPT.12.25.20552	Lincoln	40	SR 1359 (LONG CIRCLE)	NC 27 TO SR 1360	1	2	NO	NO	0.56	20	7,228	7,228	3,614		
2018CPT.12.25.20552	Lincoln	41	SR 1360 (LONG CIRCLE)	SR 1359 TO NC 27	1	2	NO	NO	0.58	20	7,486	7,486	3,743		
2018CPT.12.25.20552	Lincoln	42	SR 1396 (KILLIAN FARM RD.)	NC 73 TO GASTON COUNTY LINE	1	2	NO	NO	3.13	20	40,398	40,398	20,199	15	
2018CPT.12.25.20552	Lincoln	43	SR 1718 (CINNABAR LN.)	NC 27 TO SR 1360	1	2	NO	NO	0.2	19	2,452	2,452	1,226		
2018CPT.12.25.20552	Lincoln	44	SR 1194 (WESTWINDS RD)	FROM NC 27 TO SR 1002	1	2	NO	NO	0.48	20	5,632	5,632	2,816		
2018CPT.12.25.20552	Lincoln	45	SR 1493 (MCGEE RD)	FROM NC 27 TO END MAINT	1	2	NO	NO	0.43	18	4,541	4,541	2,270		
2018CPT.12.25.20552	Lincoln	46	SR 1187 (PAUL ELMORE RD)	FROM SR 1201 TO SR 1185	1	2	NO	NO	0.99	19	11,035	11,035	5,520		
2018CPT.12.25.20552	Lincoln	47	SR 1180 (GEORGE BROWN RD)	FROM NC 182 TO SR 1169	1	2	NO	NO	2.72	18	28,723	28,723	14,365	15	
2018CPT.12.25.20552	Lincoln	48	SR 1179 (LEONARDS FORK CH RD)	FROM NC 182 TO SR 1180	1	2	NO	NO	1.95	18	20,592	20,592	10,300		
2018CPT.12.25.20552	Lincoln	49	SR 1178 (DAVE HEFNER RD)	FROM SR 1180 TO SR 1177	1	2	NO	NO	1.19	18	12,566	12,566	6,285		
2018CPT.12.25.20552	Lincoln	50	SR 1110 (BUD DAVIS RD)	FROM SR 1109 TO SR 1111	1	2	NO	NO	0.81	19	9,480	9,480	4,740		
TOTAL FOR PROJ NO. 2018CPT.12.25.20552											27.97	344,103	344,103	174,477	60
GRAND TOTAL											63.86	788,145	788,145	396,009	120

PROJECT NO.	SHEET NO.	TOTAL NO.
2018CPT.12.25.20232, 2018CPT.12.25.20552	16	17

THERMOPLASTIC AND PAINT QUANTITIES

PROJECT NO	COUNTY	MAP NO	ROUTE	DESCRIPTION	TYP NO	LANES	LANE TYPE	LENGTH		WORK ZONE ADVANCE/GENERAL WARNING SIGNING	TEMPORARY TRAFFIC CONTROL	4" WHITE PAINT	4" YELLOW PAINT
								MI	FT				
								SF	LS				
2018CPT.12.25.20232	Cleveland	1	SR 1107 (DAVIS RD)	NC 18 TO NC 180	1	2		2.04	18	148	*	43,901	43,901
2018CPT.12.25.20232	Cleveland	2	SR 1136 (OLD BUFFALO CH. RD.)	SR 1140 TO SC STATE LINE	1	2		1.32	20	116	*	28,406	17,424
2018CPT.12.25.20232	Cleveland	3	SR 1160 (BARCLAY RD)	SR 1161 TO SR 1159	1	2		0.81	20	84	*	17,431	17,431
2018CPT.12.25.20232	Cleveland	4	SR 1168 (LATTIMORE RD)	SR 1162 TO US 74	1	2		2.28	18	180	*	49,066	49,066
2018CPT.12.25.20232	Cleveland	5	SR 1352 (CROWDER RIDGE RD.)	SR 1350 TO SR 1361	1	2		3.02	18	180	*	64,990	59,864
2018CPT.12.25.20232	Cleveland	6	SR 1356 (DOTY RD.)	SR 1350 TO SR 1325	1	2		0.86	20	84	*	18,507	18,507
2018CPT.12.25.20232	Cleveland	7	SR 1373 (5 POINTS RD.)	SR 1361 TO NC 226	1	2		2.61	VAR. 18-20	148	*	56,167	56,167
2018CPT.12.25.20232	Cleveland	8	SR 1528 (LARGO DR.)	SR 1524 TO DEAD END	1	2		0.45	20	84	*	9,684	9,684
2018CPT.12.25.20232	Cleveland	9	SR 1558 (CHARLIE RANDAL RD.)	NC 182 TO DEAD END	1	2		0.72	18	84	*	15,494	15,494
2018CPT.12.25.20232	Cleveland	10	SR 1376 (HOLLIS RD.)	NC 226 TO SR 1377	1	2		3.07	20	180	*	64,839	64,839
2018CPT.12.25.20232	Cleveland	11	SR 1658 (GREEN FARM RD.)	SR 1657 TO LINCOLN COUNTY LINE	1	2		0.09	18	84	*	1,937	1,937
2018CPT.12.25.20232	Cleveland	12	SR 1662 (WILL DIXON RD.)	NC 182 TO SR 1643	1	2		2.07	20	148	*	44,546	44,546
2018CPT.12.25.20232	Cleveland	13	SR 1663 (PHILADELPHIA RD.)	NC 182 TO SR 1662	1	2		0.35	18	84	*	7,532	7,532
2018CPT.12.25.20232	Cleveland	14	SR 1377 (HOLLIS RD.)	RUTHERFORD COUNTY LINE TO SR 1376	1	2		0.33	18	84	*	6,970	6,970
2018CPT.12.25.20232	Cleveland	15	SR 1379 (MT. HARMONY CH. RD.)	NC 226 TO END OF PAVEMENT	1	2		0.28	18	84	*	5,914	5,914
2018CPT.12.25.20232	Cleveland	16	SR 1804 (JIM ELLIOT RD./ED HAMRICK RD.)	SR 1908 TO SR 1808	1	2		3.6	20	180	*	77,472	77,472
2018CPT.12.25.20232	Cleveland	17	SR 1824 (DICK SPANGLER RD.)	SR 1826 TO NC 18	1	2		1.05	20	116	*	22,596	22,596
2018CPT.12.25.20232	Cleveland	18	SR 1825 (PLAINFIELD DR.)	SR 1824 TO SR 1808	1	2		1.32	20	116	*	28,406	28,406
2018CPT.12.25.20232	Cleveland	19	SR 1826 (CORNWELL RD.)	SR 1824 TO SR 1005	1	2		1.26	20	116	*	27,115	27,115
2018CPT.12.25.20232	Cleveland	20	SR 1828 (OAKVALE DR.)	NC 18 TO SR 1827	1	2		0.8	18	84	*	17,216	10,560
2018CPT.12.25.20232	Cleveland	21	SR 1829 (WALLACE GROVE RD.)	NC 18 TO SR 1827	1	2		0.94	20	84	*	20,229	18,408
2018CPT.12.25.20232	Cleveland	22	SR 1830 (RIDGEDALE DR.)	NC 18 TO SR 1827	1	2		0.91	20	84	*	19,583	12,012
2018CPT.12.25.20232	Cleveland	23	SR 1900 (PONY BARN RD.)	NC 182 TO DEAD END	1	2		0.7	18	84	*	15,064	15,064
2018CPT.12.25.20232	Cleveland	24	SR 1901 (CHAROLAIS DR.)	NC 18 TO SR 1001	1	2		0.93	18	84	*	20,014	20,014
2018CPT.12.25.20232	Cleveland	25	SR 1902 (CHARITY CH. RD.)	SR 1901 TO SR 1967	1	2		0.22	18	84	*	4,734	4,739
2018CPT.12.25.20232	Cleveland	26	SR 1904 (PLEASANT GROVE CH. RD.)	NC 18 TO SR 1804	1	2		0.5	18	84	*	10,760	10,760
2018CPT.12.25.20232	Cleveland	27	SR 1923 (E. SANDERS RD.)	NC 18 TO SR 1908	1	2		2.03	18	116	*	43,686	41,796
2018CPT.12.25.20232	Cleveland	28	SR 1924 (ARLEE DR.)	NC 180 TO SR 1923	1	2		1.02	20	84	*	21,950	21,950
2018CPT.12.25.20232	Cleveland	29	SR 1967 (CHARITY CH. RD.)	SR 1902 TO DEAD END	1	2		0.31	18	84	*	6,671	6,671
TOTAL FOR PROJ NO. 2018CPT.12.25.20232					1			35.89		3,172	*	770,880	736,839
2018CPT.12.25.20552	Lincoln	30	SR 1002 (CAT SQUARE RD.)	CATAWBA COUNTY LINE TO NC 27	1	2		5.88	22	408	*	126,538	126,538
2018CPT.12.25.20552	Lincoln	31	SR 1115 (S. HEBRON CH. RD.)	NC 27 TO NC 18	1	2		1.21	18	116	*	26,039	26,039
2018CPT.12.25.20552	Lincoln	32	SR 1127 (CEDAR GROVE CH. RD.)	SR 1128 TO SR 1113	1	2		0.78	18	150	*	16,786	16,786
2018CPT.12.25.20552	Lincoln	33	SR 1130 (BILL LEDFORD RD)	SR 1002 TO SR 1129	1	2		1.36	20	84	*	29,267	29,267
2018CPT.12.25.20552	Lincoln	34	SR 1192 (JIM WISE RD)	SR 1193 TO DEAD END	1	2		0.69	20	84	*	14,849	14,849
2018CPT.12.25.20552	Lincoln	35	SR 1195 (ABERNATHY FARM RD.)	SR 1197 TO END PAVEMENT	1	2		0.7	20	84	*	14,800	14,800
2018CPT.12.25.20552	Lincoln	36	SR 1211 (HOG HILL RD.)	SR 1197 TO CATAWBA COUNTY LINE	1	2		1.61	19	116	*	34,647	34,647
2018CPT.12.25.20552	Lincoln	37	SR 1317 (MOUNT VERNON RD.)	NC 27 TO END MAINT	1	2		1.03	19	116	*	22,166	22,166
2018CPT.12.25.20552	Lincoln	38	SR 1318 (SOUTHMONT RD.)	SR 1317 TO DEAD END	1	2		0.86	18	84	*	18,507	18,507
2018CPT.12.25.20552	Lincoln	39	SR 1319 (AE STOVER RD.)	SR 1317 TO CULDESAC	1	2		0.81	19	84	*	17,431	17,431
2018CPT.12.25.20552	Lincoln	40	SR 1359 (LONG CIRCLE)	NC 27 TO SR 1360	1	2		0.56	20	84	*	12,051	12,051
2018CPT.12.25.20552	Lincoln	41	SR 1360 (LONG CIRCLE)	SR 1359 TO NC 27	1	2		0.58	20	84	*	12,482	12,482
2018CPT.12.25.20552	Lincoln	42	SR 1396 (KILLIAN FARM RD.)	NC 73 TO GASTON COUNTY LINE	1	2		3.13	20	180	*	67,358	67,358
2018CPT.12.25.20552	Lincoln	43	SR 1718 (CINNABAR LN.)	NC 27 TO SR 1360	1	2		0.2	19	84	*	4,304	4,304
2018CPT.12.25.20552	Lincoln	44	SR 1194 (WESTWINDS RD)	FROM NC 27 TO SR 102 (SHOAL RD)	1	2	2WU	0.48	20	84	*	10,140	10,140
2018CPT.12.25.20552	Lincoln	45	SR 1493 (MCGEE RD)	FROM NC 27 TO END MAINT	1	2	2WU	0.43	18	84	*	9,081	9,081
2018CPT.12.25.20552	Lincoln	46	SR 1187 (PAUL ELMORE RD)	FROM SR 1201 (GILBERT RD) TO SR 1185 (DANIELS RD)	1	2	2WU	0.99	19	84	*	20,910	20,910
2018CPT.12.25.20552	Lincoln	47	SR 1180 (GEORGE BROWN RD)	FROM NC 182 TO SR 1169 (COUSE RD)	1	2	2WU	2.72	18	148	*	57,450	57,450
2018CPT.12.25.20552	Lincoln	48	SR 1179 (LEONARDS FORK CH RD)	FROM NC 182 TO SR 1180 (GEORGE BROWN RD)	1	2	2WU	1.95	18	116	*	41,200	41,200
2018CPT.12.25.20552	Lincoln	49	SR 1178 (DAVE HEFNER RD)	FROM SR 1180 (GEORGE BROWN RD) TO SR 1177 (PLEASANT GROVE CH RD)	1	2	2WU	1.19	18	116	*	25,135	25,135
2019CPT.12.07.20552	Lincoln	50	SR 1110 (BUD DAVIS RD)	FROM SR 1109 (SAM HOUSER RD) TO SR 1111 (PEELER RD)	1	2	2WU	0.81	19	48	*	16,900	16,900
TOTAL FOR PROJ NO. 2018CPT.12.25.20552								27.97		2,438	*	598,041	598,041
GRAND TOTAL								63.86		5,610	1	1,368,921	1,334,880

SIGNING FOR ASPHALT SURFACE TREATMENT

LEGEND

- ◻ PORTABLE SIGN
- └ STATIONARY SIGN
- ← DIRECTION OF TRAFFIC FLOW

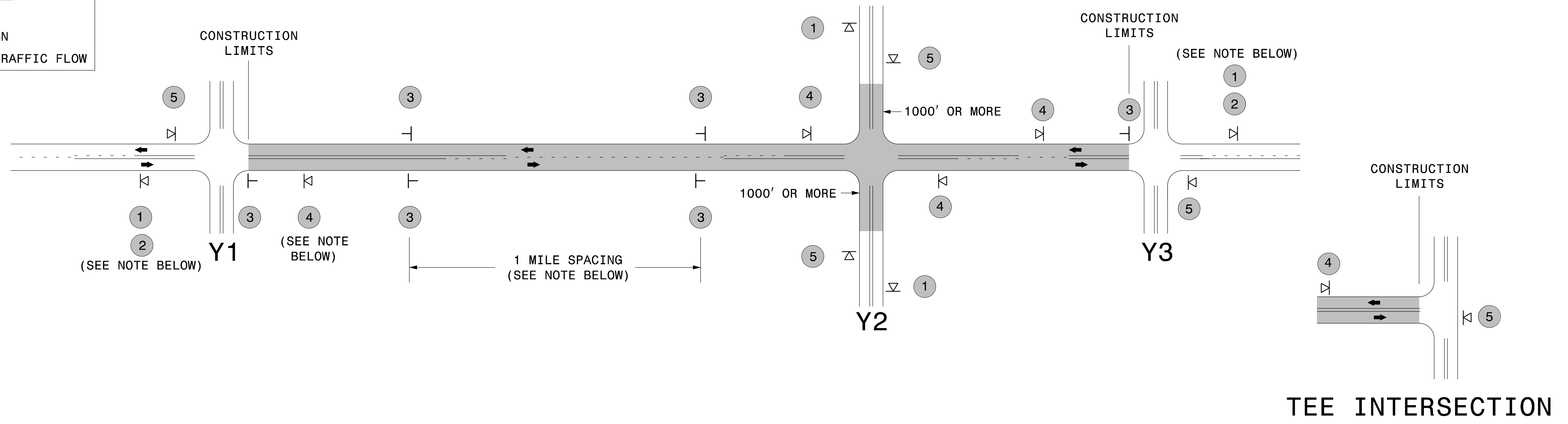

MAINLINE (-L-) SIGNING

-Y- LINE SIGNING

SIGNING NOTES AND PLACEMENT PER DIRECTION	1		PLACE 1000' PRIOR TO BEGINNING OF CONSTRUCTION LIMITS. ONLY USED ON -Y- LINES IF RESURFACING LIMITS EXTEND 1000' ALONG -Y- LINE.
	2		SIGN #2 ONLY USED WHEN RESURFACING LIMITS ARE 2 OR MORE MILES IN LENGTH. ROUND UP TO THE NEAREST WHOLE NUMBER. DO NOT USE FRACTIONAL OR DECIMAL NUMBERS.
	3	 	ALTERNATE THE FOLLOWING TWO SIGNS: - STARTING WITH "LOOSE GRAVEL" (W8-7) FOLLOWED BY "UNMARKED PAVEMENT". - PLACE INITIALLY AT THE CONSTRUCTION LIMITS AND SPACED 1 MILE APART THEREAFTER. - AT TEE INTERSECTIONS INSTALL INITIALLY 0.5 MILE FROM INTERSECTION AND SPACE 1 MILE APART THEREAFTER.
	4		THESE ARE FOR -Y- LINES THAT ARE "THROUGH" ROADWAYS. DEAD END AND SUBDIVISION ROADS ARE NOT "THROUGH" ROADWAYS. - INSTALL 500' +/- FROM EACH -Y- LINE APPROACH AS SHOWN ABOVE. - FOR MULTIPLE -Y- LINES THAT ARE SEPARATED BY 0.25 MILES OR LESS, TREAT AS A SINGLE UNIT AND INSTALL WITHIN 500' OF EACH APPROACH. - A MAXIMUM OF 2 SIGN SETS PER MILE. DO NOT INSTALL WHEN -Y- LINES ARE WITHIN 0.5 MILES FROM "END ROAD WORK" SIGN.
	5		PLACE 500' FOLLOWING THE END OF CONSTRUCTION LIMITS OR AS SHOWN WHEN WORK ENDS AT A 3-WAY TEE INTERSECTION.

STATIONARY SIGNING NOT REQUIRED FOR THE FOLLOWING -Y- LINE CONDITIONS:

- 1) LESS THAN 1000' OF RESURFACING ALONG -Y- LINE
- 2) SUBDIVISION ROADS
- 3) DEAD END ROADS

WHEN PAVING/CONSTRUCTION ACTIVITIES PROCEED ACROSS AN UNSIGNED -Y- LINE, PORTABLE ADVANCE WARNING SIGNS SHALL BE USED ALONG THE -Y- LINE AS SHOWN BELOW. REMOVE UPON COMPLETION OF WORK.

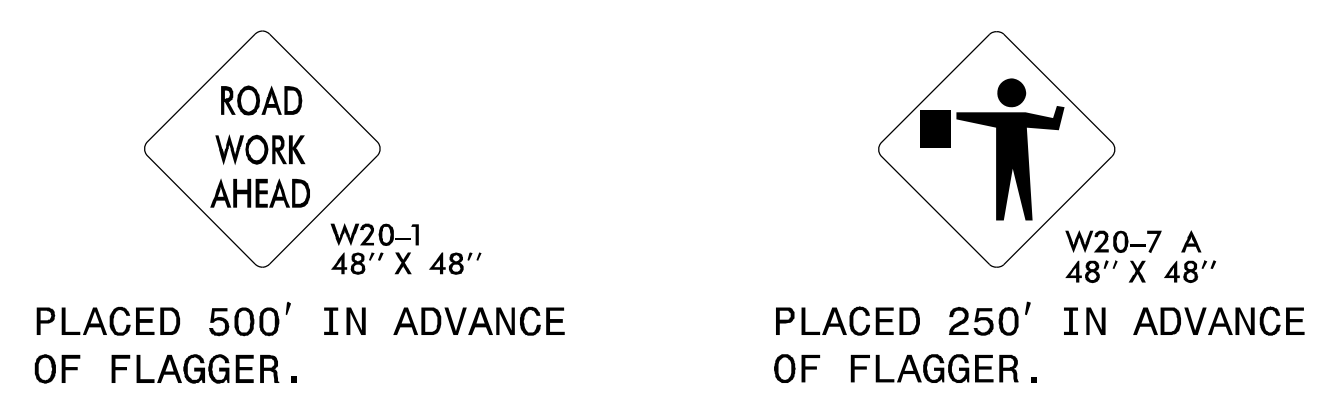

THE ABOVE SIGNS ARE ALL THAT ARE REQUIRED FOR A CONTRACTOR TO BEGIN A RESURFACING CONTRACT. ANY ADDITIONAL SIGNS REQUESTED BY NCDOT DIVISIONS SHALL BE INSTALLED WITHIN 7 BUSINESS DAYS OF THE START OF CONTRACT WORK.

MAPS LESS THAN 2 MILES

FOR AST RESURFACING MAPS WITH CONSTRUCTION LIMITS LESS THAN 2 MILES IN LENGTH, USE A STATIONARY "LOOSE GRAVEL" SIGN AT THE BEGINNING CONSTRUCTION LIMIT FOLLOWED BY AN "UNMARKED PAVEMENT" SIGN MIDWAY THROUGH AND AN "END ROAD WORK" SIGN AT THE END CONSTRUCTION LIMIT.

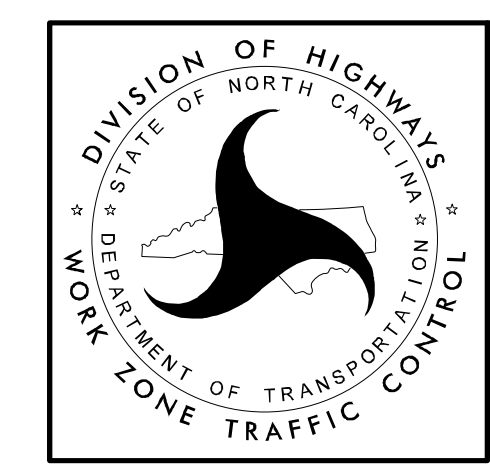

ADVANCE WARNING SIGNS FOR 2-LANE ROADWAY ASPHALT SURFACE TREATMENT